



**Installation:** Safe Area  
**Insulation Class:** I



**LIGHTING FIXTURE**

	CEI / EN
EXECUTION	INDUSTRIAL WEATHERPROOF
RULES OF COMPLIANCE	EN 60598-1 + A1; EN 60598-2-1; EN 60598-2-3
EC Type-Examination Certificate	-
PROTECTION DEGREE	IP66
AMBIENT TEMPERATURE	-

**Mechanical characteristics**

Body	die-cast aluminum
Diffuser	tempered glass 4mm thickness
Anchorage	cured poles Ø45-60mm (Ø40 with adapter)
Reflector	CUT-OFF optic - anodized and polished 99,85 pure aluminum
Painting	thermosetting polyester powder resistant to atmospheric agents and corrosion grey RAL 7038/7039 colour
Screws	stainless steel
Gaskets	silicon rubber gasket running around the body
Cable entry	from pole

**Electrical characteristics**

Power supply	conventional ballast 230V - 50Hz (P.F. CORRECTED - $\cos \rho \geq 0,95$ )
Lampholders	porcelain E27 - E40 size
Internal wiring	high-temperature resistant silicon rubber insulation cables
Terminals	suitable up to 4sq/mm cables



**On Request Accessories:**

- Electronic ballast with voltage supply different than standard
- Insulation class II
- Angle/wall installation bracket
- Pole adapter - dia. 40 mm

**Technical data**

CODE	LAMP TYPE	TEMPERATURE CLASS (GAS)	TEMPERATURE CLASS (DUSTS)	LAMPHOLDER SIZE	DETAIL
<b>LIGHTING FIXTURE FOR HIGH PRESSURE MERCURY VAPOUR LAMP - POWER SUPPLY 230V 50Hz</b>					
AVANTGARDE PLUS-125HG	125 W	-	-	E-27	A
AVANTGARDE PLUS-250HG	250 W	-	-	E-40	A
AVANTGARDE XL-400HG	400 W	-	-	E-40	A
<b>LIGHTING FIXTURE FOR METAL HALIDE LAMP - POWER SUPPLY 230V 50Hz</b>					
AVANTGARDE PLUS-70MH	70 W	-	-	E-27	A
AVANTGARDE PLUS-100MH	100 W	-	-	E-27	A
AVANTGARDE PLUS-150MH	150 W	-	-	E-27	A
AVANTGARDE PLUS-250MH	250 W	-	-	E-40	A
AVANTGARDE XL-400MH	400 W	-	-	E-40	A
<b>LIGHTING FIXTURE FOR HIGH PRESSURE SODIUM LAMP - POWER SUPPLY 230V 50Hz</b>					
AVANTGARDE PLUS-70NA	70 W	-	-	E-27	A
AVANTGARDE PLUS-100NA	100 W	-	-	E-40	A
AVANTGARDE PLUS-150NA	150 W	-	-	E-40	A
AVANTGARDE PLUS-250NA	250 W	-	-	E-40	A
AVANTGARDE XL-400NA	400 W	-	-	E-40	A

**M400** Technical features

CODE	A [mm]	B [mm]	C [mm]	D [mm]	WEIGHT [Kg]	DETAIL
AVANTGARDE PLUS-125HG	719	228	387	224	10,2	A
AVANTGARDE PLUS-250HG	719	228	387	224	11,5	A
AVANTGARDE XL-400HG	719	228	387	224	12,9	A
AVANTGARDE PLUS-70MH	719	228	387	224	10,4	A
AVANTGARDE PLUS-100MH	719	228	387	224	10,4	A
AVANTGARDE PLUS-150MH	719	228	387	224	11,7	A
AVANTGARDE PLUS-250MH	719	228	387	224	11,7	A
AVANTGARDE XL-400MH	719	228	387	224	13	A
AVANTGARDE PLUS-70NA	719	228	387	224	10,5	A
AVANTGARDE PLUS-100NA	719	228	387	224	10,5	A
AVANTGARDE PLUS-150NA	719	228	387	224	11,7	A
AVANTGARDE PLUS-250NA	719	228	387	224	13	A
AVANTGARDE XL-400NA	719	228	387	224	14,3	A



Reference details

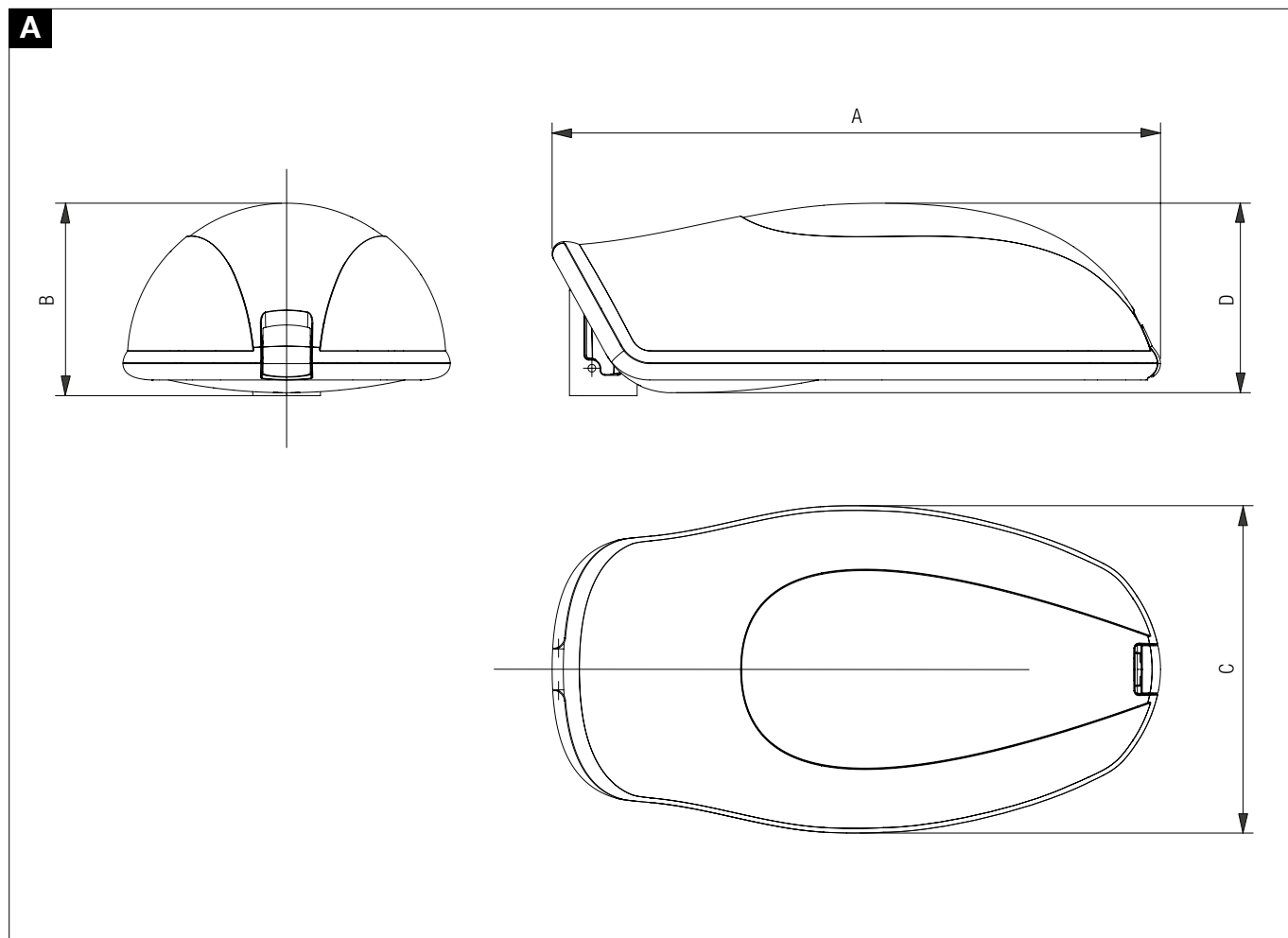

AVANTGARDE Polar diagrams - photometric data

AVANTGARDE PLUS-250HG

Luminaire Flux	10185.50 lm	Luminaire Power	250.00 W	Efficacy	40.74 lm/W	Efficiency	76.30%
Lamp Flux	13000.00 lm	Maximum value	353.80 cd/klm	Position	C=50.00 O=42.50	CG Sym.	on planes 270.00

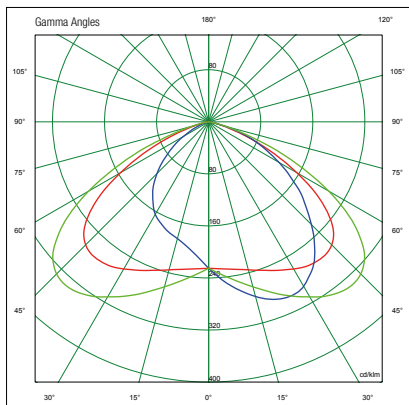
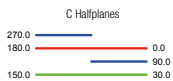

AVANTGARDE XL-400HG

Luminaire Flux	14984.50 lm	Luminaire Power	400.00 W	Efficacy	37.46 lm/W	Efficiency	68.11%
Lamp Flux	22000.00 lm	Maximum value	268.38 cd/klm	Position	C=50.00 O=35.00	CG Sym.	on planes 270.00

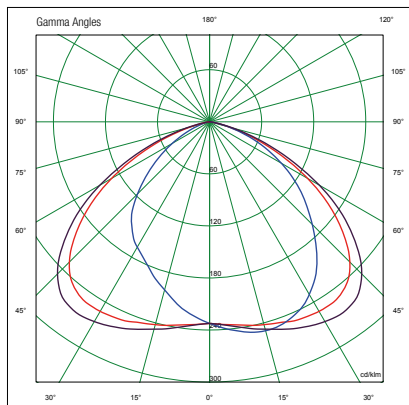

AVANTGARDE-250NA

Luminaire Flux	18117.34 lm	Luminaire Power	250.00 W	Efficacy	76.47 lm/W	Efficiency	70.80%
Lamp Flux	27000.00 lm	Maximum value	383.23 cd/klm	Position	C=30.00 O=40.00	CG Sym.	on planes 270.00

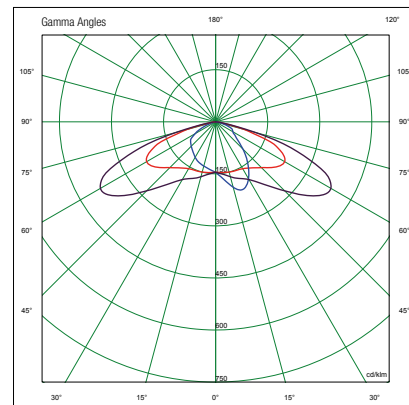
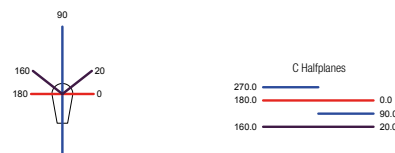

**AVANTGARDE XL-400NA**

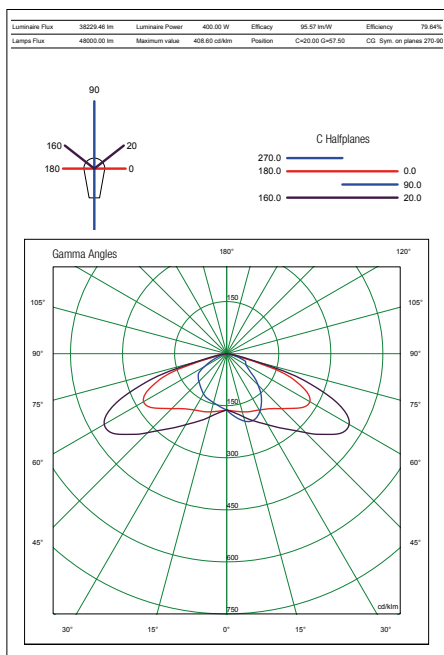

**AVANTGARDEPLUS-250MH**

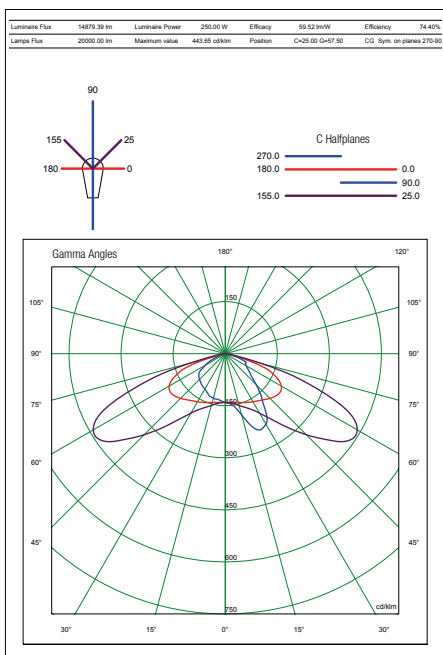

**AVANTGARDE XL-400MH**

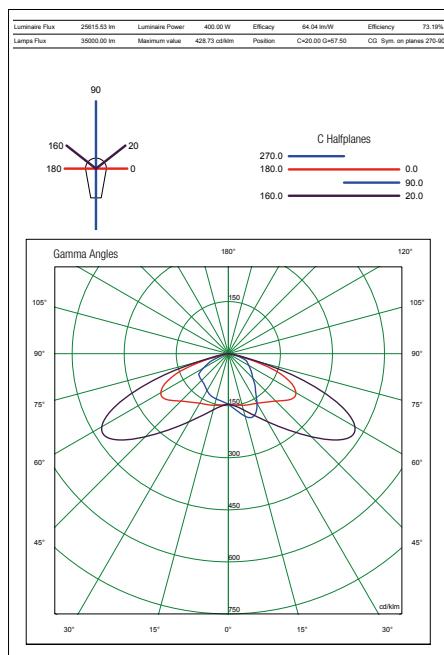

**On request accessories**

CODE	DESCRIPTION	MATERIAL
950000000	ANGLE/WALL INSTALLATION BRACKET	PAINTED STEEL
950000003	POLE ADAPTER - DIA. 40÷60MM	ALUMINIUM
950000005	POLE ADAPTER - DIA. 76 MM	PAINTED STEEL

**Angle/wall installation bracket**

**950000000**



**Pole adapter - dia. 40 mm**

**950000003**



**Pole adapter - dia. 76 mm**

**950000005**



**REMARK:**

Due to the development of the national and international specifications and of the technology, the above technical characteristics showed on this bulletin can be considered as binding on our confirmation only.

